

# AVAILABLE CUTOFFS

*Cutoffs are used when we have a non-free flow, free flow or liquid product that drips after the fill occurs. This device prevents the product from dripping, minimizes dust and decreases product waste. It can be used when filling bags, boxes, drums and various sized containers. The type of cutoff depends on the viscosity and characteristics of product flow and length the product has to drop into the container.*

## Cutoff Specifications

### Part Identification:

- \_\_\_\_\_ Dual Flapper
- \_\_\_\_\_ Cone
- \_\_\_\_\_ Plug Rod
- \_\_\_\_\_ Slide Gate
- \_\_\_\_\_ Diaphragm
- \_\_\_\_\_ Dual Arc Flapper

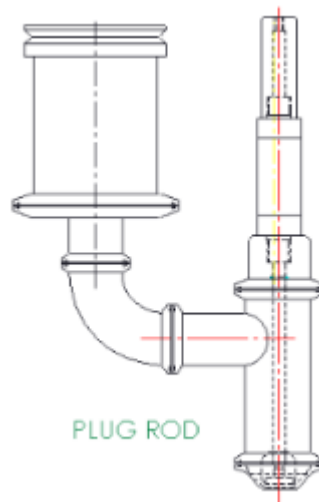
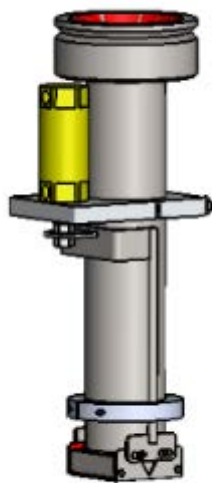
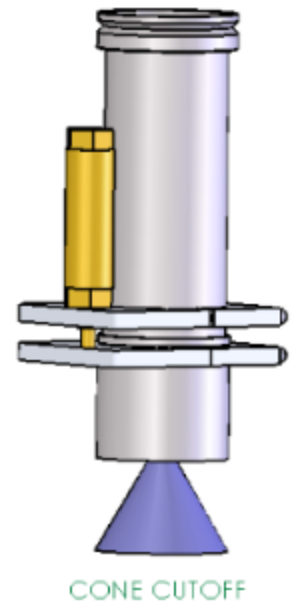
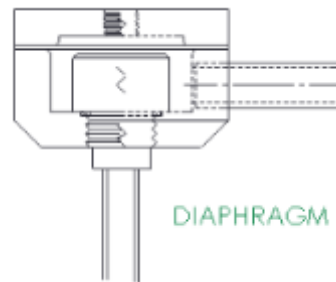
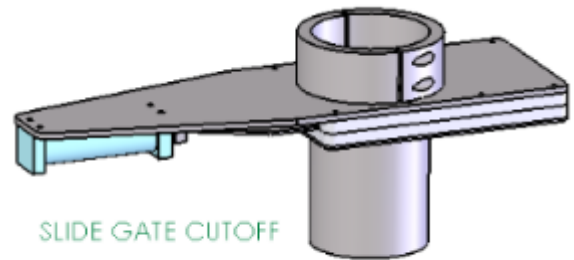

THE SPECIALIST IN FILLING APPLICATIONS FOR OVER 30 YEARS

2500 Chestnut Tree Road, Honey Brook, PA 19344  
(610) 942-4200 • FAX: (610) 942-7123 • TOLL-FREE: (800) 647-5390  
sales@amsfilling.com • www.amsfilling.com

